

Smart Pet Water Fountain

Instruction Manual

How to start the smart pet water fountain

After the smart pet water fountain powered on, press this button 6 times (pause for 2 seconds each time), and then you can search the device through the mobile phone APP.

If the device cannot be found in the mobile phone APP, please repeat the previous button operation.

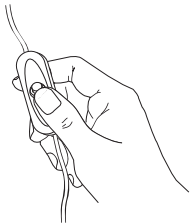

How to bind app

Step 1. App download and installation

Please scan the QR code or QR code on the packaging box to download TuyaSmart app and complete the installation.

Or manually look up TuyaSmart App on your phones app store.



Step 2. App Registration / Login

a. Account registration

- 1 Please open the "Tuyasmart" app and click "Sign up"
- 2 Please enter your email address and tick the app policy
- 3 Please input the verification code sent to your email address
- 4 Please set up your login password

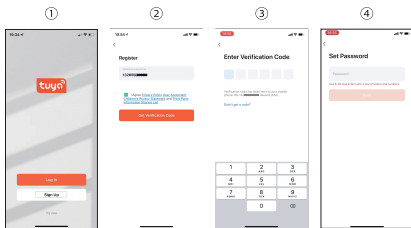

b. Login (existing Tuyasmart account)



- 1 Please click "log in"



- 2 Enter your login details and tick the app policy

Step 3: Pet Fountain Configuration



- 1 After you log in, click "add device"
- 2 Click "add" after "discovering devices"

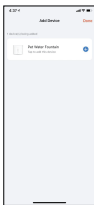

- 3 Click "*" to add Pet Water Fountain
- 4 Enter Wi-Fi Password

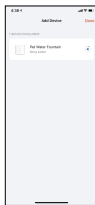

- 5 Connecting...
- 6 Device added successfully

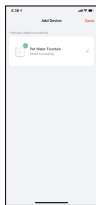

Step 4: Interface introduction

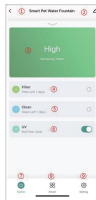

- 1 Device name, It can be modified.
- 2 Fountain information.
- 3 Water level, two status: **High** and **Low**. If it displays **Low**, it means the device lacks water. If it displays **High**, it means the device has sufficient water
- 4 Remind filter replace time.
- 5 Remind cleaning time.
- 6 Display UV running time.
- 7 Turn on / off the device.
- 8 Two status: normal and smart. (On the smart mode the settings cannot be adjusted as they are based on the recommended values. whereas on the normal mode the settings can be adjusted to your preferences)
- 9 Fountain settings: set filter replace time, UV Running time etc.

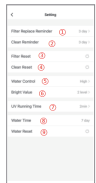

- 1 Set filter replace time.
- 2 Set clean pump, water tank time.
- 3 After replace filter, click it, start timing.
- 4 After clean pump, water tank, click it, start timing.
- 5 Adjust water stream.
- 6 Adjust the indicator light.
- 7 Set UV running time.
- 8 Set change water time.
- 9 After change water, click it, start timing.

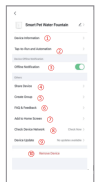

- 1 View the device ID, IP address, MAC, zone time, signal.
- 2 Tap-to-Run and Automation
- 3 If the device is offline, the APP will send a message after 30 minutes.
- 4 It can share to other mobile numbers.
- 5 Create Group.
- 6 FAQ & Feedback.
- 7 Add to Home Screen.
- 8 Check Device Network.
- 9 Device Update.
- 10 Remove device will delete the Wifi information from the device. Then use a new account to connect.